

Flow Switches – Liquid

Series FS6 High Sensitivity Liquid Flow Switches

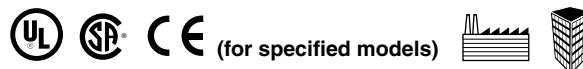

- For heavy duty applications where high sensitivity is required, such as water treatment systems, cooling systems for electronic circuits, compressors, booster pumps, and bearings, and other applications that need instant switching
- In-line configuration eliminates need for a pipe tee
- Very high flow capacity
- Actuates at extremely low flow rate
- Sizes available
 - 3/4" NPT
 - 1" NPT
- Single pole, double throw snap switch
- Switch compartment is completely sealed to protect it from the liquid
- Sensitivity adjusting screw makes flow adjustment easy
- Optional feature
 - BSPT threads
- Minimum temperature (fluid or ambient) 32°F (0°C)
- Maximum temperature 225°F (107°C)
- Maximum operating pressure 100 psi (7 kg/cm²)



Series FS6

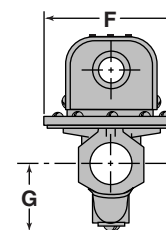
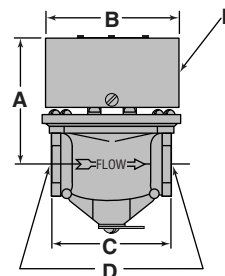

Dimensions, in. (mm)

| A | B | C | D NPT | E | F | G |
|------------|----------------|------------|----------|----------|------------|--------|
| 3 1/2 (89) | 3 23/32 (94.4) | 3 3/8 (86) | 3/4 or 1 | 7/8 (22) | 3 3/4 (95) | 2 (51) |

Model FS6-W High Sensitivity Liquid Flow Switches



- For applications requiring a water-tight, dust-tight, or a NEMA 4X rated flow switch



Model FS6-W

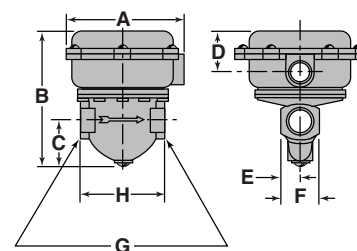

Dimensions, in. (mm)

| A | B | C | D | E | F | G NPT | H |
|---------|-------------|--------|------------|-------------|--------------|----------|------------|
| 5 (127) | 5 3/4 (146) | 2 (51) | 1 5/8 (41) | 2 9/32 (23) | 1 13/16 (46) | 3/4 or 1 | 3 3/8 (86) |

Electrical Ratings

| Voltage | Motor Switch Rating (Amperes) | | Pilot Duty |
|---------|-------------------------------|--------------|--|
| | Full Load | Locked Rotor | |
| 120 VAC | 7.4 | 44.4 | 125 VA at 120 or 240 VAC 50 or 60 cycles |
| 240 VAC | 3.7 | 22.2 | |

Flow Rates

| Pipe Size NPT in. | Settings | Mode of Operation | | Max. Flow Rate gpm (lpm) |
|-------------------------|-----------------------|-------------------|----------------------|--------------------------------|
| | | Flow gpm (lpm) | No Flow gpm (lpm) | |
| 3/4 or 1 | Factory or Minimum | .12 (.45) | .06 (.23) | 70 (265) |
| | Maximum | 2.5 (9.46) | 1.5 (5.68) | |
| | | | | |

Values are $\pm 10\%$

Ordering Information

| Model Number | Part Number | Description | Weight lbs. (kg) |
|-----------------|----------------|---|---------------------|
| FS6-3/4 | 115400 | High sensitivity flow switch 3/4" NPT body | 4.5 (2) |
| FS6-J-3/4 | 115550 | FS6-3/4 w/BSPT pipe threads | 4.5 (2) |
| FS6-1 | 115600 | High sensitivity flow switch 1" NPT body | 4.5 (2) |
| FS6-J-1 | 115650 | FS6-1 w/BSPT pipe threads | 4.5 (2) |
| FS6-W-3/4 | 115651 | FS6-3/4 w/NEMA 4X enclosure | 4.5 (2) |
| FS6-WJ-3/4 | 115653 | FS6-W-3/4 w/BSPT connections | 4.5 (2) |
| FS6-W-1 | 115652 | FS6-1 w/NEMA 4X enclosure | 4.5 (2) |
| FS6-WJ-1 | 115654 | FS6-W-1 w/BSPT connections | 4.5 (2) |
| FS6-J-3/4-E | 115551 | FS6-J-3/4 - CE conformance rated | 4.5 (2) |
| FS6-J-1-E | 115655 | FS6-J-1 - CE conformance rated | 4.5 (2) |
| FS6-WJ-3/4-E | 115656 | FS6-WJ-3/4 - CE conformance rated | 4.5 (2) |
| FS6-WJ-1-E | 115657 | FS6-WJ-1 CE conformance rated | 4.5 (2) |

See page 120 for CE Conformance information

**NOTE: DO NOT USE LIQUID FLOW SWITCHES
ON SYSTEMS WITH FLOW GREATER
THAN 10 FEET (3M) PER SECOND.**